

CHICHESTER SOCIETY



CHICHESTER CITY CENTRE PUBLIC REALM IMPROVEMENTS

GREG OCKWELL (GROWTH PROGRAMME DELIVERY MANAGER)

DAVE LAMBERT (MAJOR PROJECTS MANAGER)

JUNE 2026



Why I'm here



- Growth & One Public Estate (OPE)
- Background of the Public Realm improvements
- How designs have developed
- Project updates – where we are today
- Key milestones for the project
- *Wayfinding and interpretation
- Questions and discussion

Background – Growth & OPE

- Public and partnership concerns re maintenance and safety
- Historic information/data collated demonstrate the need for action
- However, studies to date have only given high level picture and presented unattainable option. Study work was 'non-intrusive' and had no designs.
- Deterioration of the public realm – is a maintenance liability for WSCC
- Risk of Chichester not keeping pace regionally and with changing high street uses
- Cited as a priority in Growth Deal and Chichester Vision documents



Background

- Building on evidence gathering and existing precedents
- Focus on uses
- Engagement and gathering support from partners
- Political prioritisation and funding
- Appointed WSP to draft concept ideas based on key drivers
- Public engagement on initial option



Project development

3 Landscape Strategy

East Street - Option One Proposals

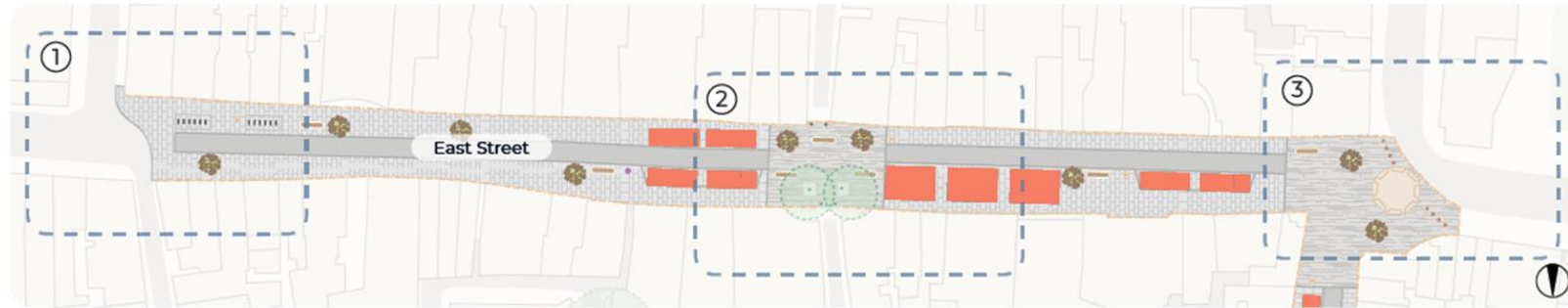

Key Design Features



Integration of Copenhagen inspired crossing points at the entrance of North and East Street. This looks to reduce the appearance of vehicle accessibility and therefore promote a street space that is pedestrian priority. However an accessible vehicular route through the street is still provided for servicing and emergency vehicles.

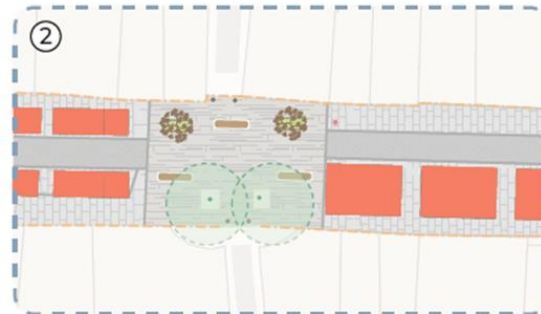

Key nodes and break out spaces within the street will reduce the linearity of the street environment and provide opportunity to escape busier areas during events such as market days. These areas will be enhanced through higher quality materials, seating provision and raised planters to increase greening of the street. These spaces are located in key places that link to historic properties as well as routes to the wider city.

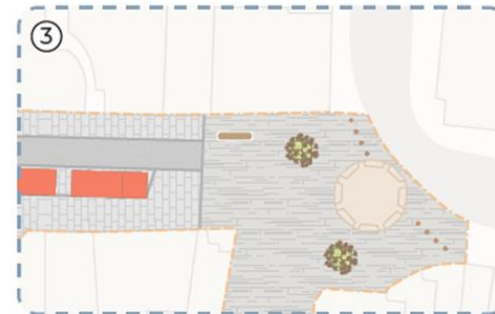

The central space around the Market Cross will be enhanced through the provision of high quality natural stone finish as well as utilising seating and planters to improve the functionality and appearance. Any vehicle delineation has been removed, although an unobstructed route that connects north and east street will be maintained for 1 way vehicle movement whilst reducing opportunities for turning around.

- Design principles
- Baseline options
- Initial key stakeholder input
- Hard wearing/ cost effective materials
- Planters

Project development



- Public and partner feedback was key to updating the designs
 - More trees/ planting
 - More heritage materials and features
 - **Mobile connectivity**
 - Just get on with it!!
- Incorporating feedback into design costs more
- CCC, CDC, CIL, LRSF and WSCC capital funding the scheme
- Cost benefit and VFM in the business case and WSCC key decision

Project development- digital



Strong feedback from the public engagement

- Working with WSCC Digital Infrastructure team
- Delivering high-speed reliable connectivity across Chichester city centre.
- Future proofing for the implementation of next-gen technologies; 5GSA IoT, AI, Smart technologies.
- Integrated with the public realm improvement to reduce disruption and boost economic, social and environmental benefits.
- The network being built will be shared by all three MNOs, enabling all of them to utilise the newly installed equipment.

- Construction ahead of the main public realm installation July – December 2027
- Further communications will be released shortly

Project development

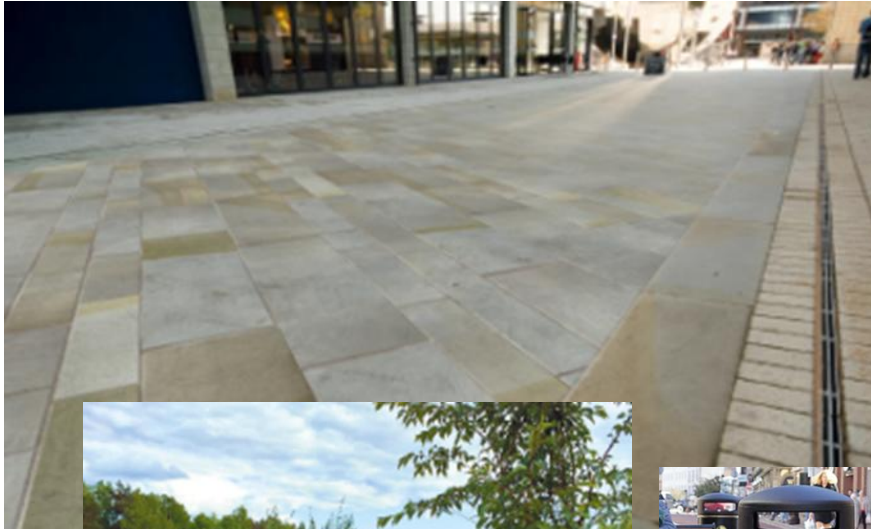

Heritage materials
Upgraded and refreshed
furniture
Planting
Digital connectivity

Further 'look and feel' examples

Castle street, Llangollen



Further 'look and feel' examples



Winchester High Street (Mildren construction)



Updated visuals

North Street from St Peters



Updated visuals

North Street, Crane st junction



Updated visuals

North Street, Crooked S junction



Updated visuals

East Street, Little London junction



Further investment

- Project has levered in further investment or brought forward planned works as part of the construction phase programme
- This includes the digital element, but also planned maintenance works
- Further grant funding for other improvements may become available as a result of this initial investment

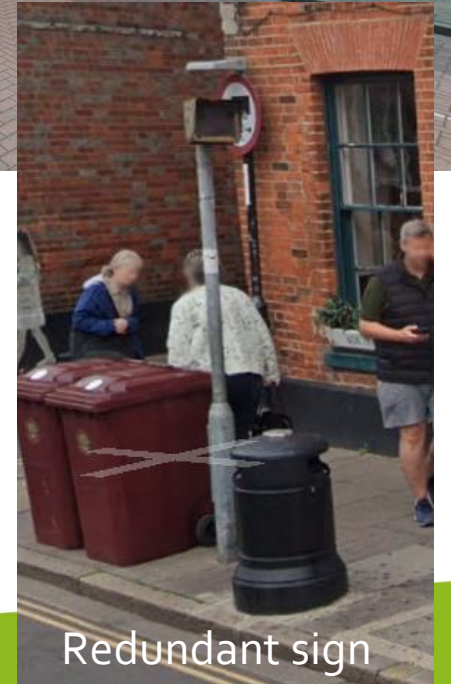
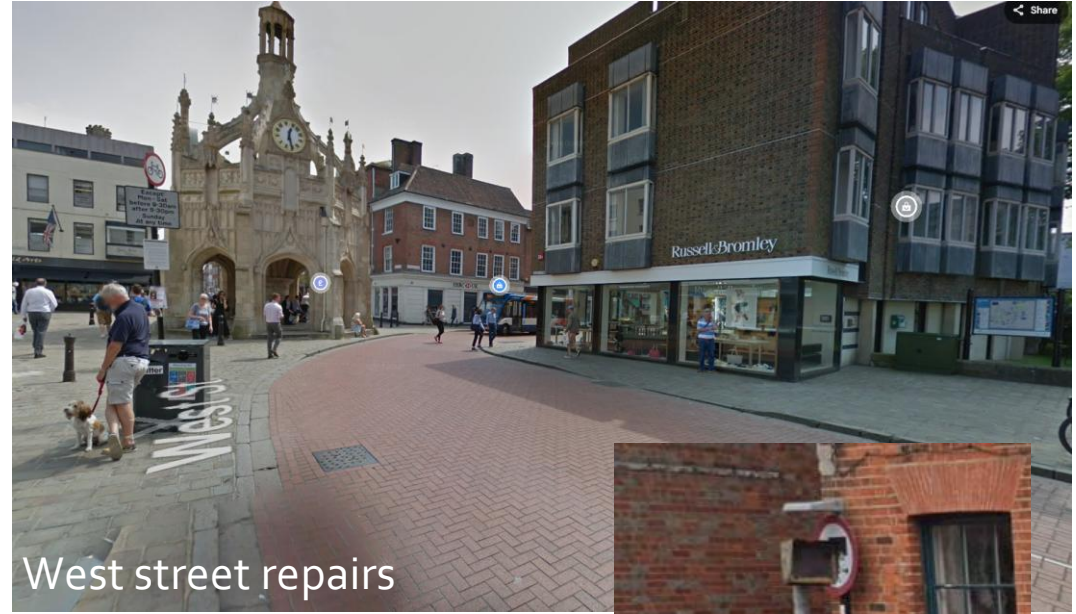

Project Update



- Detailed design phase expected finish in end of June '26
- Formal procurement process to start after design issued. April 2027 start on site anticipated (TBC)
- Digital works into project – timeline ahead of construction (expected go live December '26)
- Continued stakeholder (internal and external) engagement
- Communication associated with above in development

Updated Project Milestones and dates



Wayfinding and interpretation



- One element of the design still to be decided and requires working with a range of stakeholders including:
 - Chichester Society,
 - Chichester BID,
 - Chichester City Council
 - Chichester District Council
- Wayfinding is holistic system of info, architecture, and design that guides people through physical spaces
- Why it matters: When well-executed, wayfinding is a strategic tool for boosting accessibility, and steering foot traffic toward specific hubs and points of interest. Can be used to boost the local economy

Wayfinding and interpretation

*indicative



- Specific opportunity to develop wayfinding in the new landscape
- Input into the information, interpretation that links with existing landmarks and trails
- Signs, paving, engraving and sculptural options
- Give the space and give sense of place



Installation art to facilitate movement into town centre



Opportunity for lighting in paving

Wayfinding and interpretation



Portland Square, Worthing



Brisbane



Worthing

- Other examples and precedents across WS and beyond
- Can include digital, braille and other accessibility options



Southampton



Eastgate Square, Chichester

Questions and discussion

